

Embedded CT-32RT-12V

Programming and Operation Instructions

Before you begin

- Motors are shipped without limit switch settings and transmitter ID's.
- Steps **(1-7)** must be completed to ensure proper shade programming and functionality.
- Power should **ONLY** be connected to current shade being programmed. All other shades should be disconnected from their respective power while programming is in progress.
- While programming steps **(4 & 5)**, shade should not be inactive for longer than 2 ½ minutes or motor will exit programming mode.

STEP 1- Connect Power to Motor

- 1) Connect power source to motor
 - Motor should already be installed in shade

STEP 2- Assign a Transmitter - (for use with Telis 1 & 4, Decora 1 & 4 or Chronis Timer)

For Single Channel Transmitters (Telis 1, Decora 1, or Chronis)

- 1) On the transmitter, press and hold the **UP** and **DOWN** buttons simultaneously until the shade "jogs".

For Multi-Channel Transmitters (Telis 4 or Decora 4)

- 1) Using the channel selector, select the desired channel.
- 2) On the transmitter, press and hold the **UP** and **DOWN** buttons simultaneously until the motor "jogs".

Note: This step cannot be performed if transmitter has already been programmed (addressed) to shade.

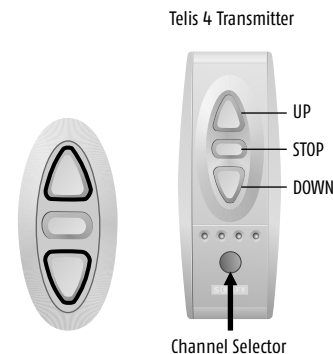

STEP 3- Check Polarity (Shade Direction)

MUST BE DETERMINED BEFORE SETTING SHADE LIMITS

- 1) Press and hold the **UP** or **DOWN** button. The Shade movement (direction) should correspond to the directional button on the Transmitter. (i.e, Up Button on the Transmitter = Up movement for Shade)
 - If shade direction is correct, continue to **Step 4**.
 - If shade direction is not correct (in reverse), press and hold the **CENTER (Stop)** button on the transmitter for 5 seconds. Shade will jog (DOWN then UP) Shade direction is now corrected. Shade movement should now correspond to the direction button on the transmitter.



STEP 4- Setting the Upper Limit (UP Stop Location)

- 1) Press and hold the **UP** button on the transmitter. Shade will PULSE initially then begin to move in the UP direction.
Note: If shade stops prior to reaching desired limit (final shade position) release then press and HOLD transmitter UP button again until shade continues to move.

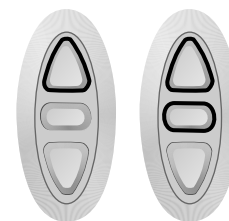

- 2) Once desired shade position is reached, release transmitter directional button, then press the **CENTER (Stop)** and **UP** buttons together until the shade "jogs" confirming the set position.

STEP 5- Setting the Lower Limit (DOWN Stop Location)

- 1) Press and hold the **DOWN** button on the transmitter. Shade will PULSE initially then begin to move in the DOWN direction.
Note: If shade stops prior to reaching desired limit (final shade position) release then press and hold transmitter DOWN button again until shade continues to move.

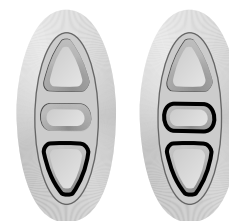

- 2) Once desired shade position is reached, release transmitter directional button, then press the **CENTER (Stop)** and **DOWN** buttons together until the shade "jogs" confirming the set position.

STEP 6- Completing & Exiting Programming Mode

- 1) Press and hold the **PROGRAM** button on the back of the transmitter until the shade "jogs."
TRANSMITTER IS NOW ADDRESSED AND PROGRAMMING IS COMPLETE.

Note: If power is disconnected from shade before STEP 6 is completed, **TRANSMITTER WILL NOT BE ADDRESSED to the programmed shade.** This feature is useful if shade MUST BE addressed to an existing Transmitter. (see Assigning Transmitter to Shade **STEP 2**)

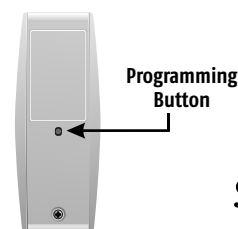

STEP 7- Addressing Transmitters or Specific Transmitter Channels

Adding Additional Transmitters (Single channel)

- 1) Press and hold the **PROGRAM** button on the **previously addressed transmitter** until the shade "jogs."
 - 2) Press and hold the **PROGRAM** button on the Additional (new) transmitter until shade "jogs."
- Additional (new) transmitter is now added to shade memory and can be used to operate shade.

Assigning Specific Channels to Shade (Multi-channel transmitters only)

- 1) Press and hold the **PROGRAM** button on the **previously addressed transmitter** until the shade "jogs."
 - 2) Select the desired channel (1-4 or all) by momentarily pressing the Channel Selector Button on the multi-channel transmitter.
 - 3) Press and hold the **PROGRAM** button on the multi-channel transmitter until shade "jogs."
- Additional (new) channel is now added to shade memory and can be used to operate shade.

Note: To Prevent unwanted Channel/Transmitter assignments, ALL PREVIOUSLY PROGRAMMED SHADES should be UNPLUGGED until Programming is complete.

Deleting Specific Channels/Transmitters

- 1) Press and hold the **PROGRAM** button on the **previously addressed transmitter** until the shade "jogs."
 - 2) Select the desired channel (1-4 or all) or transmitter (single channel) to be deleted.
 - 3) Press and hold the **PROGRAM** button on transmitter until shade "jogs."
- Channel or transmitter is now deleted from shade memory and will not operate shade.

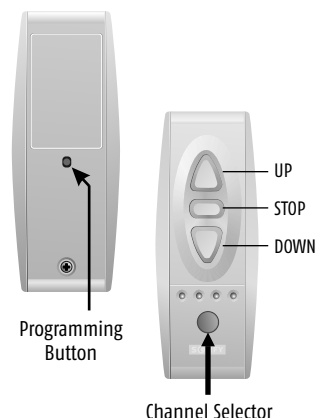

STEP 8- Resetting Motor (Erasing all Previously Programmed Limit Settings and Channels)

- 1) Insert reset tool into connector on motor.
- 2) Press and hold the **PROGRAM** button located on the RESET TOOL until LED blinks rapidly and extinguishes. (Motor is now reset. Proceed to steps 1-7)

OPTION 1- Setting an Intermediate Shade Position (IP)

- 1) Press the **UP** or **DOWN** directional button on the **previously addressed transmitter** until the shade reaches a desired intermediate position, then press the **CENTER (Stop)** button to stop. (adjust shade position accordingly)
 - 2) Press and hold the **CENTER (Stop)** button on the transmitter until shade "jogs." Intermediate position is now added to memory.
 - 3) Activate the shade intermediate position by pressing the **CENTER (Stop)** button from ANY shade position. **Note:** Shade should be inactive prior to activating intermediate position function. If shade is actively moving (in-motion) **CENTER (Stop)** button should be pressed twice.
- To Delete:** Activate shade to (IP) position, then press and hold the **CENTER (Stop)** button for 5 seconds.

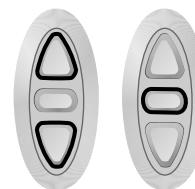

OPTION 2- Re-adjusting Upper Limit (UP Stop Position)

- 1) Press the **UP** directional button on the transmitter. Shade will travel to the pre-set UP limit.
- 2) Press and hold the **UP** and **DOWN** buttons simultaneously on the transmitter until shade "jogs."
- 3) Press and hold either the **UP** or **DOWN** button on the transmitter to adjust shade to new position.
- 4) Press and hold the **CENTER (Stop)** and **UP** Button together until shade "jogs." New Upper Limit (Up Stop position) is now added to memory.

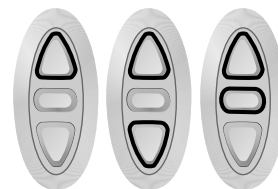

OPTION 3- Re-adjusting Lower Limit (DOWN Stop Position)

- 1) Press the **DOWN** directional button on the transmitter. Shade will travel to the pre-set DOWN limit.
- 2) Press and hold the **UP** and **DOWN** buttons simultaneously on the transmitter until shade "jogs."
- 3) Press and hold either the **UP** or **DOWN** button on the transmitter to adjust shade to new position.
- 4) Press and hold the **CENTER (Stop)** and **DOWN** Button together until shade "jogs." New Lower Limit (Down Stop position) is now added to memory.

